

# HR23S Series

# ATTENUATOR

## Au-plated contacts

Low contact resistance

## Small size

23.5mm square

## Multiple contact

31positions (0dB - Cut off)

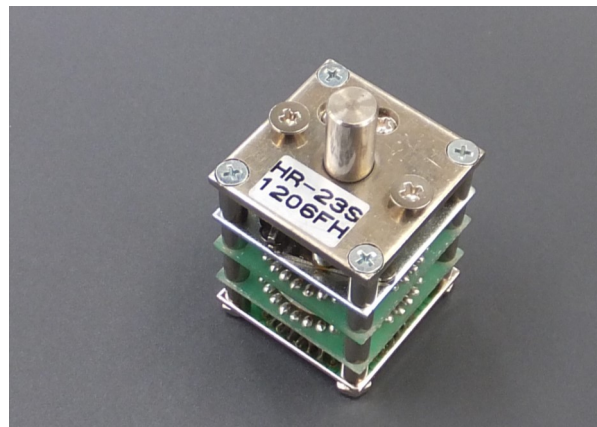

## Dimensions

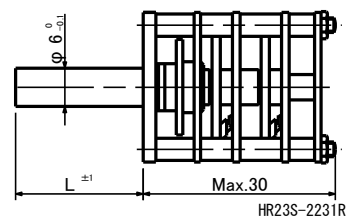
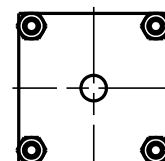
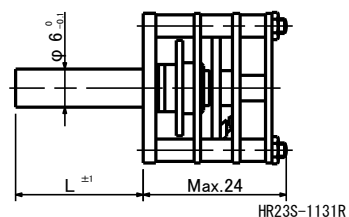
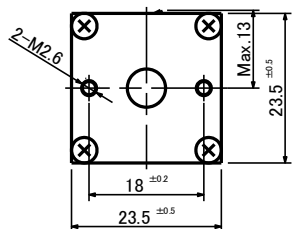

Terminals (Top view) \*Terminal number is not printed.

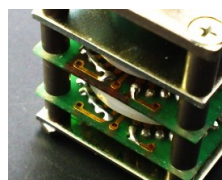
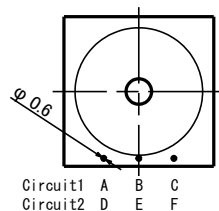

## Model number

<b>HR23S</b>	-	<b>1131</b>	<b>R</b>	-	<b>L1</b>	-	<b>10K</b>
Product type		Number of circuit 1131: single circuit 2231: 2 circuits			Control shaft length L1: 10.5mm L2: 20mm		Total resistance

## Circuit method

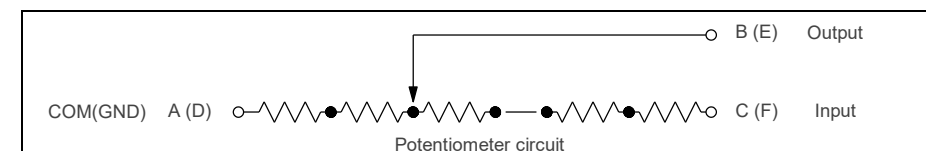

## Electrical specifications

	HR23S-1131R	HR23S-2231R
Circuit method	Potentiometer (stepped)	
Attenuation (Load: High)	0, 1, 2, 3, ... (1dB step)... , 11, ... (1.5dB step)..., 20, ... (2dB step)..., 30, 32.5, 35, 37.5, 40, 43, 46, 50, Cut off	
Attenuation accuracy	±0.3dB	
Max attenuation	50dB ±0.5dB	
Cut off	80dB Min.	
Matching accuracy	-	0.2dB or less (0dB - 50dB)
Number of circuit	1	2
Impedance	10kohm, 100kohm ±3%	
Insertion loss	0.3dB or less	
Input level	Max. 0.1W	
Frequency range	DC ~ 20kHz	
Voltage proof	1 Min. at AC100V	
Insulation resistance	100Mohm or more at DC500V	
Rotational life	30,000 Cycles Min. (18cycles/min, Attenuation accuracy: ±0.5dB or less)	

## Mechanical specifications

	HR23S Series
Operating angle	30degrees ±2degrees
Step angle	10degrees ±1degrees
Strength of nut-attached	50Ncm
Attached parts	M2.6 x 4mm
Stopper strength	50N
Push-pull strength	50N

## Other specifications

	HR23S Series
Temp. range	-10 to +70 degrees C (Operating), -15 to +75 degrees C (Storage)
Relative humidity	90%RH (No condensation)

## Note

- \* Solder heat resistance: 350degrees C max, 5sec max, 2 times. (Manual soldering only)
- \* Please take care during soldering that the smoke from the solder does not flow inside a switch.
- \* Special order is not acceptable.
- \* High impedance: Infinity. (or more than 20 times of total resistance)